

Monday to Thursday..... 7 a.m. to 9 p.m.
Friday..... 7 a.m. to 3 p.m.
Saturdays, Sundays, and
College Holidays..... CLOSED
Finals Week..... Hours vary
Intersession and Summer..... Hours vary
Check the Library Website for
Up-to-Date Information.



Text: (562) 418-5253
Circulation Desk: (562) 908-3416
Reference Desk: (562) 908-3484
riohondocollegelibrary@gmail.com
www.riohondo.edu/library

2nd Floor, Learning Resource Center
Río Hondo College, Main Campus

Services for Students

Library Card and Circulation Desk

You need to know your Río Hondo student ID number and have a picture ID in order to borrow materials. You may borrow up to 10 items, including technology. Students can also borrow materials from Cal State L.A. Check RHC Library's website for details: www.riohondo.edu/library.

DVDs, phone chargers, headphones, noise canceling head sets, and Reserve books are for library use only. Technology that may be available to take home includes calculators, hotspots, laptops, and chromebooks. Ask Library staff at the Circulation Desk about availability.

Books, Periodicals, and OneSearch

RHC Library has thousands of books for research and pleasure reading like graphic novels and popular reading books, as well as ebooks. Books on shelves are organized by the Library of Congress Classification System.

Print magazines and newspapers are available for library use only. Digital magazines as well as thousands of other periodicals are available through online databases.

Find library materials through the online OneSearch: gorio.page/LibOneSearch.

Online Databases

Río Hondo College students can use any of the online databases for research through the Library's database page (gorio.page/LibDatabases) or through AccessRío.

If you are off-campus, you will be prompted to log into AccessRío to access the databases. Students can also visit Cal State L.A. for single-day access to CSULA's databases.

Printing and Photocopying: Copy Center

Print from any of the Library's computers or wireless from your laptop. Retrieve your prints at the Copy Center located next to the Circulation Desk, using your AccessRío credentials. The self-service Copy Center also has photocopiers for your use. Prints or copies are \$0.10 (black and white) or \$0.50 (color) per page. Add cash to your MyPrint account at the Copy Center, or add money online (myprint.riohondo.edu) with your debit/credit card or PayPal account.

Research Help and Reference Desk

Need help finding a book, using a database, refining a research question, or using citation formats? Librarians are available in person at the Reference Desk or by phone, chat, email, and text:

Call (562) 908-3484

Text (562) 418-5253

Email riohondocollegelibrary@gmail.com

Reserve and Reference Materials

Some textbooks and course materials are in the **Reserve Collection** for **2-hour library use only**, and can be borrowed at the Circulation Desk. Check OneSearch (gorio.page/LibOneSearch) or ask a librarian for help.

The **Reference Collection** (encyclopedias, dictionaries, and other reference materials) is for **library use only**.

Group Study Rooms

Study rooms can be reserved for up to 6 people and can be used for up to 2 hours a day. There are 7 study rooms available. Go to gorio.page/rhclstudy to book a room. You may book a group study room up to a week in advance.

Computers and Laptops

The Library has more than 40 computer workstations located near the Reference Desk, and 10 Macs. Sign into any available PC using your **AccessRío username and password**. To extend your time on the computer or for any computer help, ask a librarian at the **Reference Desk**. No sign-in is required for the Macs.

Scanners

There are 2 desktop scanners available for free use at computers in front of the Reference Desk. There is also a BookEye Scanner at the Copy Center which can be used for high speed scanning of textbooks for free. Save files with a flash drive.

Library Research Guides

Library research guides, or **LibGuides**, are created for students to revisit the research sources and techniques taught in Library orientations. They are available 24 hours a day, at libguides.riohondo.edu or from the library website.

Follow us on:



@riohondolibrary



Study Room Reservations



MyPrint



OneSearch (Library Catalog)



Library Website

LIBRARY

LEARNING RESOURCE CENTER

2nd FLOOR

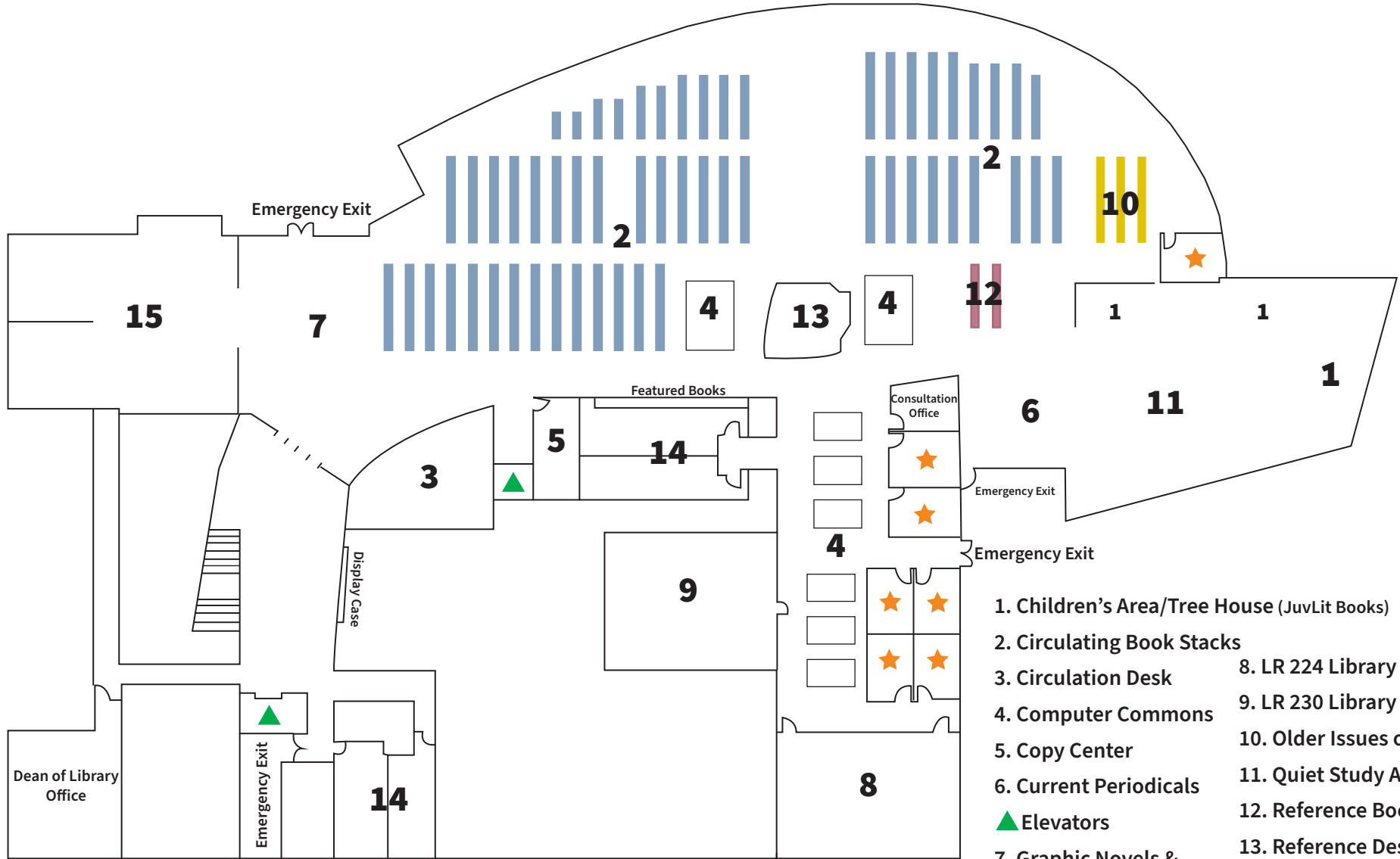

- 1. Children's Area/Tree House (JuvLit Books)
 - 2. Circulating Book Stacks
 - 3. Circulation Desk
 - 4. Computer Commons
 - 5. Copy Center
 - 6. Current Periodicals
 - 7. Graphic Novels & Popular Books
 - 8. LR 224 Library Classroom
 - 9. LR 230 Library Classroom
 - 10. Older Issues of Periodicals
 - 11. Quiet Study Area
 - 12. Reference Books
 - 13. Reference Desk
 - 14. Restrooms
 - 15. Lounge area
- ▲ Elevators
- ★ Group Study Rooms

If you have any questions, please ask a Librarian at the Reference Desk!

No Food or Drinks Except Water